

Storage and handling on site

HANDLING

This information shows how trusses may be handled such that no structural damage occurs. It does not infer a safe lifting method for site staff who should take note of both H.S.E. Lifting Regulations and Construction (Design and Management) Regulations 1994. Mechanical handling for unloading and erecting trusses safely is strongly recommended.

Trusses may become damaged by incorrect handling. During transportation, they may, of necessity, also be inverted. When mechanically handled, the trusses should be banded together in sets and supported when lifting utilizing a spreader bar, as shown in fig 2.

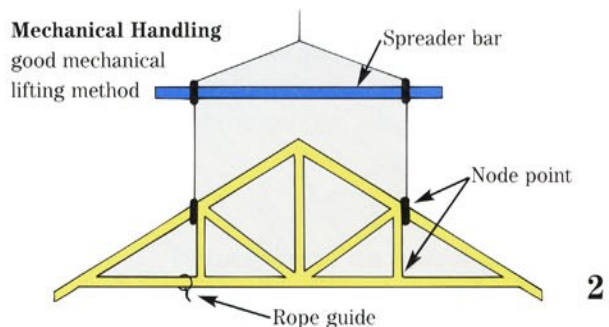
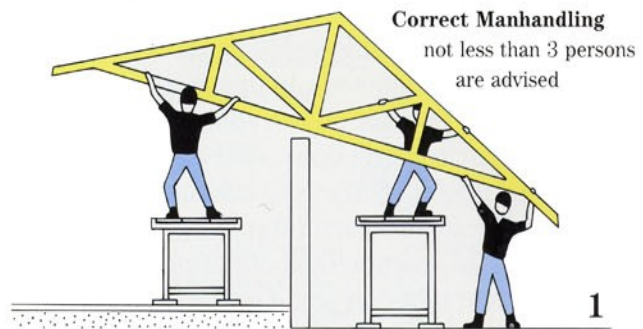

TYPICAL TRUSS WEIGHTS	
35mm thick fink truss = 35 kg	
47mm thick attic truss = 110 kg	
3 ply 35mm thick howe girder = 160 kg	
NB: Weights given are for guidance only. For lifting and handling check actual truss weights	

STORAGE

It is imperative to prevent damage or deformation to trusses awaiting erection. They should be stored as illustrated (3 & 4) and protected from sun and rain. Adequate allowance must be made for ventilation.

